

Jayco | Greyhawk Class C Motorhome

GREYHAWK

DESIGNED & ENGINEERED FOR THE JOURNEY



2+3
YEAR YEAR
WARRANTY

STANDARDS & OPTIONS



DOVER



Wood



Floor



Countertop

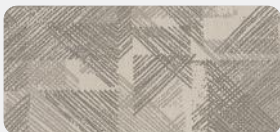

Main Fabric



Furniture

MODERN FARMHOUSE

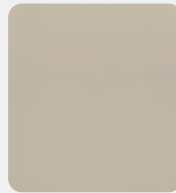

Wood

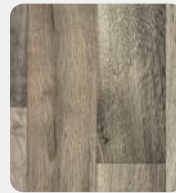

Floor



Countertop



Main Fabric

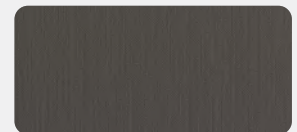

Furniture

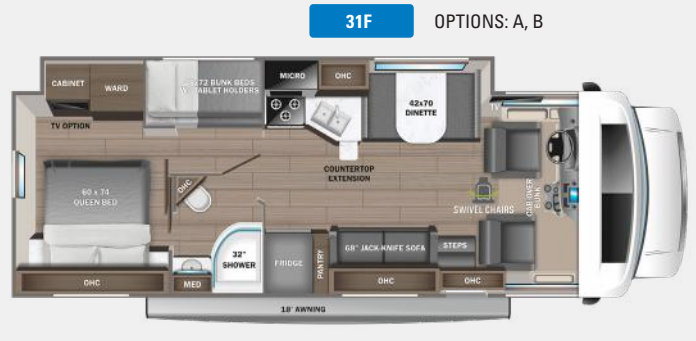
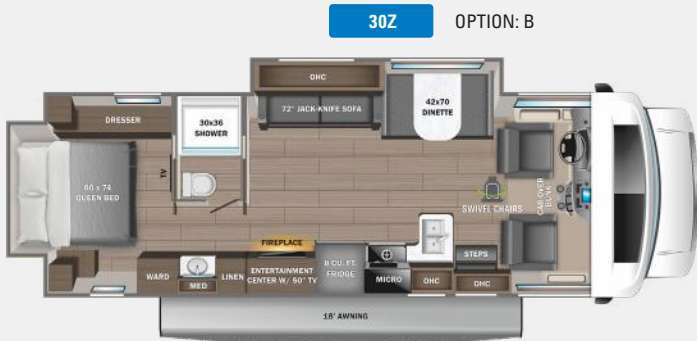
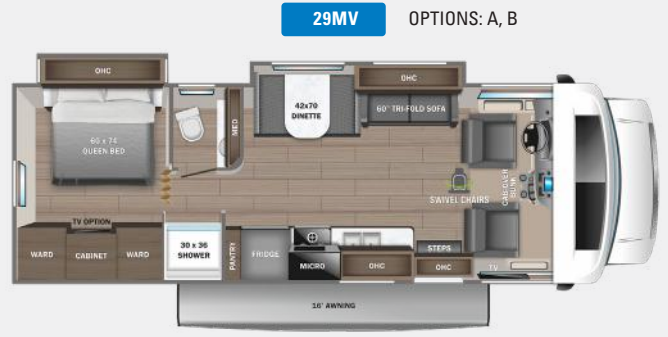
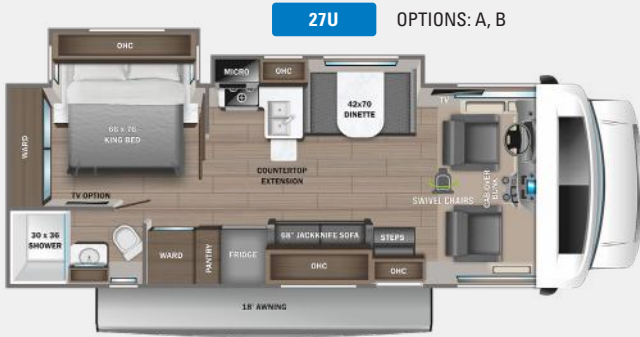

OPTIONS

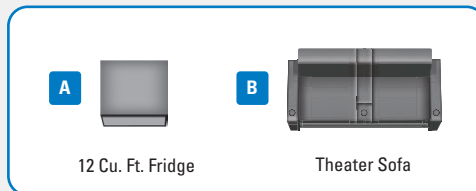

EXTERIOR SELECTIONS



Starburst Full-Body Paint



Skylight Full-Body Paint



Starry Night Full-Body Paint



Standard Graphics Package

STANDARDS & OPTIONS

CUSTOMER VALUE PACKAGE

JRIDE® PLUS: Computer-balanced driveshaft, Koni® FSD shocks, heavy-duty rear stabilizer bar, standard front stabilizer bar, Hellwig® helper springs, rubber isolation mounts
Automatic hydraulic leveling jacks
Frameless windows
Electric patio awning with LED lights
15,000 BTU A/C with heat pump
1,000W inverter
Sony® infotainment center with Apple® CarPlay™ and Android Auto™
Backup and side-view cameras
LED HD Smart TV in living area

DRIVING

Ford® E-450 chassis
GVWR- 14,500 lb.
GCWR- 22,000 lb.
7.3L V-8 325 HP engine with 450 ft.-lb. torque
6-speed TorqShift® series transmission with overdrive
210 amp alternator
E-rated highway tires- LT225/75R16
Tire pressure monitoring system (TPMS)
Power anti-lock brakes with power steering
7,500 lb. hitch with 750 lb. tongue capacity and 7-pin plug
12V chassis battery
55 gal. fuel tank
Chrome, heated, remote-controlled, side-view mirrors
Swivel driver and passenger seats
Driver and passenger airbags
Power windows and door locks
Tilt steering wheel
A/C and cruise control
Auxiliary start switch
Privacy curtains for cab area

EXTERIOR

StrongholdVBL™ roof, floor and sidewalls
Bead-foam insulation (R-24 max roof, R-9 max floor, R-5 max walls)
One-piece, seamless, fiberglass front cap
Automotive-bonded, panoramic window in front cap with power shade
One-piece, seamless, crowned fiberglass roof
Fiberglass running boards and transition wings
Fiberglass exterior walls with vinyl graphics
Remote keyless cab entry
Entrance door with industry's largest travel-view window
Electric-powered entrance step with integrated house battery compartment
12V house battery
200W solar panel with dual controller with second house battery
(2) high-output, marine-grade exterior speakers
Slideout awning(s)
Lockable storage compartments with slam latches
Heated holding tanks (12V pads)
16.5 gal. propane tank (56 lb.)
LP quick-connect hookup

Exterior utility center
Winterization drain system
Black tank flush
Outside shower
12V demand water pump
Onan® 4,000W MicroQuiet™ generator with auto-changeover
Transfer switch with reverse polarity protection
30 amp electrical service
Third brake light
Roof ladder (N/A 30Z)
4 in. bumper tube with sewer hose storage

INTERIOR

84 in. interior ceiling height with padded vinyl ceiling
High-intensity, recessed LED ceiling lights
LED-lit hardwood fascia
Hardwood cabinet doors and drawers
Ball-bearing drawer guides
Jayco-exclusive, easy-operation legless dinette table
2-point lap safety belts in all designated seating locations
Interior command center
Blackout night roller shades
30,000 BTU auto-ignition furnace
Electric fireplace (30Z)
6 gal. gas/electric DSI auto-ignition water heater
Prep for satellite dish
Cable TV hookup with RG-6 coax
Winegard 2.0 Wi-fi/4G antenna
Furrion® all-in-one cooktop and oven
Residential-size microwave
Recessed stainless steel kitchen sink with cutting board and grate sink cover
LED-lit countertops
Flip-up countertop extension (select models)
Decorative kitchen backsplash
Pop-up charging station with 110V outlet and USB plugs
Water filtration system
Shower with decorative surround, glass door, skylight and light
Stainless steel bathroom sink
Toilet with foot flush
Powered roof vent in bathroom with wall switch
Walk-around queen-size bed with bedspread and nightstands
USB port and wireless charging in nightstands
Under-bed storage (select models)
Large wardrobes
Overhead bunk with 750 lb. capacity and safety net
Bunks with industry-exclusive 300 lb. capacity each (31F)
Wall-mounted tablet holder in each bunk (31F)
Smoke alarm
Carbon monoxide detector

OPTIONS

Dual A/C units with power management system
12 cu. ft. refrigerator (29MV, 31F, 27U)
Theater seating
Aluminum rims
Folding windshield sun shade
LED HD Smart TV in bedroom

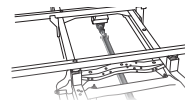

COMPUTER-BALANCED DRIVESHAFT

Ensures smooth and efficient power transfer to the wheels

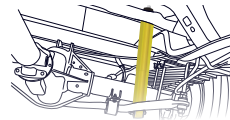

KONI® SHOCK ABSORBERS

Controls bounce and sway when driving over expansion joints and rough roads

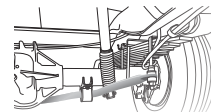

HEAVY-DUTY REAR STABILIZER BAR

A larger bar and polyurethane bushings, instead of rubber, transfer power faster for extra support, more stability and easier handling

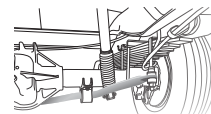

STANDARD FRONT STABILIZER BAR

Reduces the body roll of a vehicle during cornering or over road irregularities

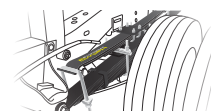

HELLWIG® HELPER SPRINGS

Work with the chassis' existing springs to give the RV more support, improving stability under heavy loads



RUBBER ISOLATION MOUNTS

Positioned near the tires to absorb road shock, dampen noise and minimize vibrations

FLOORPLAN	GVWR (lbs.)	GCWR (lbs.)	WHEEL BASE	OVERALL LENGTH	EXTERIOR HEIGHT WITH SATELLITE AND A/C	EXTERIOR WIDTH	INTERIOR HEIGHT	FRESH WATER CAPACITY (gal.)	GRAY WASTE WATER CAPACITY (gal.)	BLACK WASTE WATER CAPACITY (gal.)
27U	14,500	22,000	195"	29' 11"	11' 8"	100"	84"	43	41	31
29MV	14,500	22,000	223"	32' 6"	11' 8"	100"	84"	47	41	32
30Z	14,500	22,000	223"	32' 6"	11' 8"	100"	84"	44	41	31
31F	14,500	22,000	223"	32' 6"	11' 8"	100"	84"	47	41	31

Meet your Jayco Dealer



Scan QR code for specification definitions

Some specs at the time of print may include estimates.

For the most updated information, please visit Jayco.com/greyhawk

Jayco, Inc. | P.O. Box 460 | Middlebury, IN 46540

See dealer for further information and prices. All information in this brochure and on www.jayco.com is the latest available at the time of publication approval. Jayco reserves the right to make changes and to discontinue models without notice or obligation. Photography may show optional equipment or props used for decoration purposes only. RVs built for sale in Canada may differ to conform to Canadian codes. JAYCO and the JAYCO BIRD IN FLIGHT are registered trademarks of Jayco, Inc. Printed in USA 3/23 ©2023 Jayco, Inc. 2032605.2023



Jayco - Part of Jayco Family of Companies